

MD65xx image barcode scanner quick guide

- ☞ A standard packing includes a scanner, a USB cable and a CD (or a user manual).
- ☞ Accessories include a RS232 cable, a 5V adaptor and a PS2 cable.
- ☞ Use a piece of dry and soft cloth when cleaning the scanner is in need.

Parts of the scanner

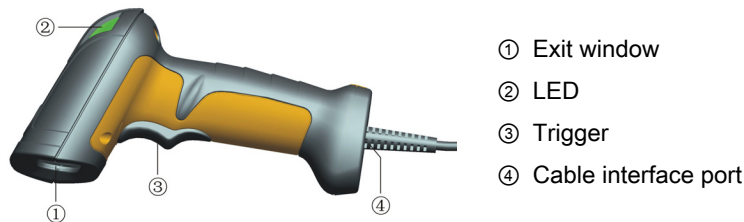

Installing the cable

1. Switch off the host;
2. Refer to the below pictures, connect the host with the scanner based on different cables;
3. Ensure that all connections are secure.
4. Switch on the host system. If the installation is successful, the beeper will beep and LED will light.

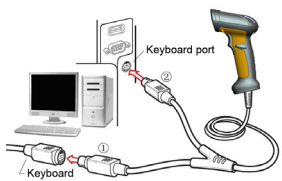

PS2 cable

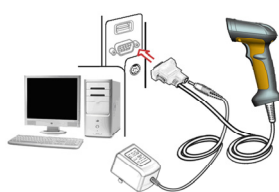

RS232 cable

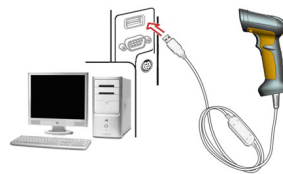

USB cable

Return default parameters and version information



Default value initialization



Firmware version list

Programming instruction and example

Two alternate programming modes have been provided as follows:

✓ Single-scan setting

Scan the appropriate
Single-scan setting

Example: to set Flow control to be XON/XOFF.

✓ Multiple-scan setting

Scan "Option bar code"

Scan "the 1st character of option"

Scan "the 2nd character of option"

Scan "END"

Example: to set Flow control to be XON/XOFF.

Reading techniques

1. Press and hold the trigger, an aiming beam is projected which is suggested to be centered over the barcode.
2. In general, the optimal reading range is limited to 5-7cm regardless of the size of the minimal element of the barcode.
3. On a successful reading, the scanner will beep once, and the illumination and aiming patterns die out. Then the scanner transmits barcode message to the host.

